



£ 430000

3 Bed House - Detached, Clere Gardens, Chineham, Basingstoke

Barons Estate Agents are delighted to present this three bedroom detached family home, situated in a cul de sac in Chineham. Internally, the property features an entrance hallway, cloakroom, lounge, kitchen/dining room, utility room and conservatory on the ground floor. Upstairs, there are three bedrooms, a family bathroom and an ensuite. Externally, the property boasts driveway parking, a garage and a large rear garden. Additional benefits include gas central heating, double glazing and NO ONWARD CHAIN. An early viewing would be strongly advised by the vendor's sole agent.

Location

Clere Gardens is situated in Chineham, one of Basingstoke's most desired residential areas. Amenities near by include Chineham shopping centre which offers an Iceland, Marks & Spencer, Tesco and a host of other shops and restaurants. Basingstoke town has an abundance of amenities which include the award winning Festival Place shopping centre along with a vast selection of eateries, theatres, a museum and bars. There is a mainline train to London Waterloo in 45 minutes, A33 and M3 access within a short drive along with the beautiful Hampshire countryside offering walks, golf courses, historical sites and local pubs.

Tenure

Freehold

Council Tax

Band E

Extra Services

Barons Estate Agents will recommend the services of other businesses and may receive a referral fee in some instances where a buyer or seller uses the services of that company.

🏠 KEY POINTS & FEATURES

- 🏠 Detached Three Bedroom Family Home
- 🏠 Kitchen/Dining Room
- 🏠 Conservatory
- 🏠 Garage & Driveway Parking
- 🏠 Lounge
- 🏠 Enclosed Rear Garden
- 🏠 Two Bathrooms
- 🏠 Utility Room & Cloakroom
- 🏠 NO ONWARD CHAIN





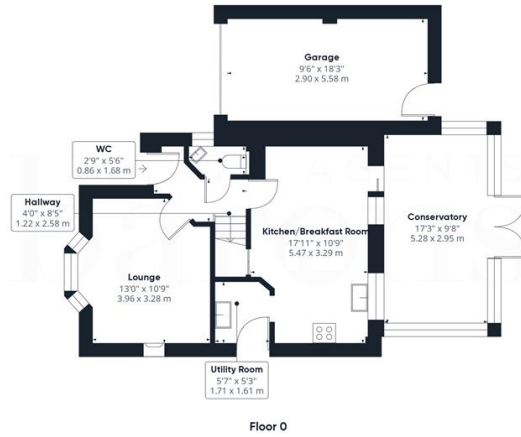

Approximate total area[®]
1151.42 ft²
106.97 m²



(1) Excluding balconies and terraces

While every attempt has been made to ensure accuracy, all measurements are approximate, not to scale. This floor plan is for illustrative purposes only.

Calculations are based on RICS IPMS 3C standard.

GIRAFFE360