



£ 280000

2 Bed House - End Terrace, Southlands, Chineham, Basingstoke

Barons Estate Agents are delighted to present this two bedroom, end of terrace property situated in Chineham. The property has been lovingly cared for and is presented to the market with NO ONWARD CHAIN. The ground floor accommodation comprises of a porch, lounge and kitchen/dining room. Upstairs, there are two bedrooms and a family bathroom. Externally, the property boasts two allocated parking spaces, a front garden and an enclosed rear garden with a sunny aspect. Additional benefits include double glazing throughout and gas central heating. A viewing is strongly advised by the vendor's sole agent.

Location

Southlands is situated in Chineham, one of Basingstoke's most desired residential areas. Amenities near by include Chineham shopping centre which offers Marks & Spencer, Tesco and a host of other shops and restaurants. Basingstoke town has an abundance of amenities which include the award winning Festival Place shopping centre along with a vast selection of eateries, theatres, a museum and bars. There is a mainline train to London Waterloo in 45 minutes, A33 and M3 access within a short drive along with the beautiful Hampshire countryside offering walks, golf courses, historical sites and local pubs.

Tenure

Freehold

Council Tax

Band C

Extra Services

Barons Estate Agents will recommend the services of other businesses and may receive a referral fee in some instances where a buyer or seller uses the services of that company.

🏠 KEY POINTS & FEATURES

- 🏠 End of Terrace Home
- 🏠 Porch
- 🏠 Enclosed Rear Garden
- 🏠 Two Bedrooms
- 🏠 Lounge
- 🏠 Two Allocated Parking Spaces
- 🏠 Family Bathroom
- 🏠 Kitchen/Dining Room
- 🏠 NO ONWARD CHAIN



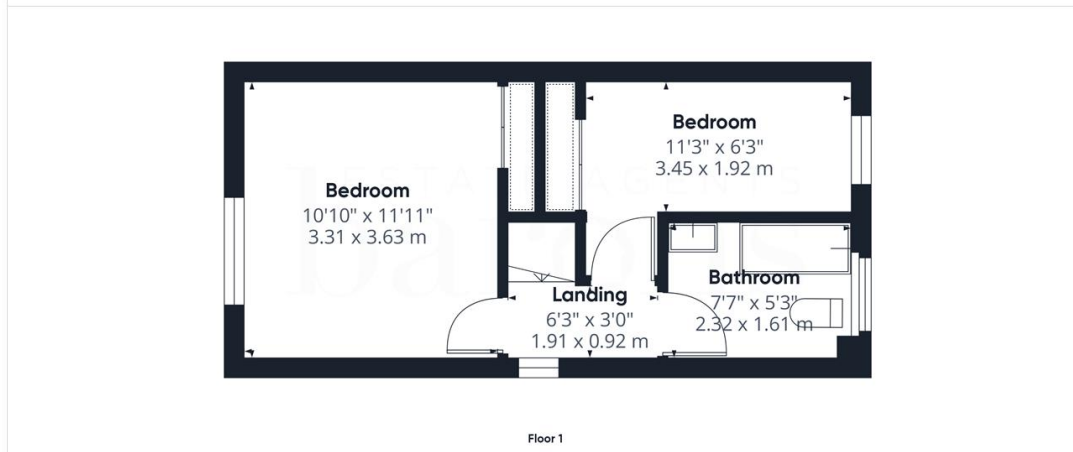
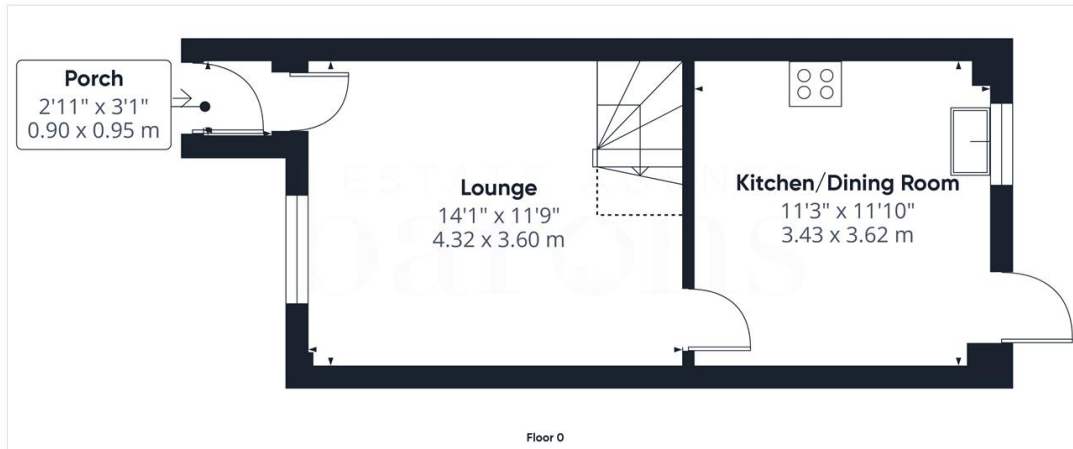

ESTATE AGENTS
barons

Approximate total area[®]
585.78 ft²
54.42 m²

Reduced headroom
7.98 ft²
0.74 m²

(1) Excluding balconies and terraces

Reduced headroom
..... Below 5 ft/1.5 m

While every attempt has been made to ensure accuracy, all measurements are approximate, not to scale. This floor plan is for illustrative purposes only.

Calculations were based on RICS IPMS 3C standard. Please note that calculations were adjusted by a third party and therefore may not comply with RICS IPMS 3C.

GIRAFFE360