



£ 450000

4 Bed House - Semi-Detached, Sheppard Road, Basingstoke

Barons Estate Agents are delighted to present to the market, this EXTENDED, semi detached family home situated in Harrow Way. The ground floor accommodation comprises; a porch, entrance hall, a 21ft lounge, separate dining room, kitchen, utility and WC. The first floor offers, 4 well proportioned bedrooms, en suite and family bathroom. Further benefits include: Driveway parking for a number of cars, garage and private enclosed rear garden. Early viewings are recommended by the owners sole agent.

## Location

The property is positioned on Sheppard Road within The Harrow Way. The excellent leisure facilities of Basingstoke are all within easy reach which include Festival Place, various bars, coffee shops and eateries. The railway station is within close proximity and provides direct access to London Waterloo for commuters (approximately 45 minutes). The M3 motorway provides road access to London and the South. There are well regarded schools and colleges within the area which include BCOT and QMC.

## Tenure

Freehold

## Council Tax

Band D

## Extra Services

Barons Estate Agents will recommend the services of other businesses and may receive a referral fee in some instances where a buyer or seller uses the services of that company.

## 🏡 KEY POINTS & FEATURES

---

- |                             |                         |                                    |
|-----------------------------|-------------------------|------------------------------------|
| 🏡 Semi Detached             | 🏡 4 Bedrooms            | 🏡 21 ft Living Room                |
| 🏡 Dining Room               | 🏡 Kitchen               | 🏡 Family Bathroom, En Suite and WC |
| 🏡 Driveway Parking & Garage | 🏡 Sought After Location | 🏡 Close to Amenities               |



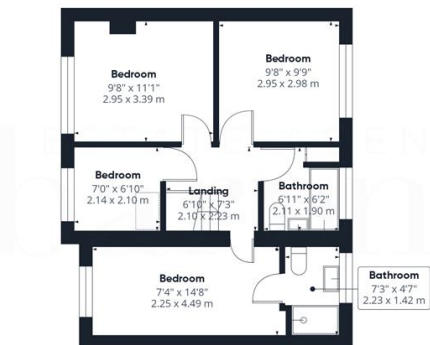

Approximate total area<sup>(n)</sup>  
1134 ft<sup>2</sup>  
105.3 m<sup>2</sup>

While every attempt has been made to ensure accuracy, all measurements are approximate, not to scale. This floor plan is for illustrative purposes only.

GIRAFFE360

