



**£ 280000**

**3 Bed House - End Terrace, Bennet Close, Oakridge, Basingstoke**

Barons Estate Agents are delighted to present this three bedroom family home, situated within close proximity of Basingstoke town centre. On the ground floor, the property features a porch with storage, an entrance hallway, cloakroom, a kitchen and a spacious lounge/dining room. Upstairs there are three bedrooms of good proportions and a family bathroom. Externally, there is an enclosed rear garden, and ample communal parking in the cul de sac. Additional benefits include gas central heating, double glazing and NO ONWARD CHAIN. A viewing of this ideal family home would be strongly recommended by the vendor's sole agent.

## Location

Bennet Close is situated in an ideal location for the growing family. With Oakridge Infant & Junior schools within 200 yards, Festival Place shopping centre, Basingstoke railway and bus station also within half a mile. Other benefits include local shops, playing fields, and access to all major road links.

## Tenure

Freehold

## Council Tax

Band C

## Extra Services

Barons Estate Agents will recommend the services of other businesses and may receive a referral fee in some instances where a buyer or seller uses the services of that company.

## 🏡 KEY POINTS & FEATURES

---

- |                              |                                    |   |
|------------------------------|------------------------------------|---|
| 🏡 End of Terrace Family Home | 🏡 Three Bedrooms                   | 🏡 Spacious Lounge/Dining Room & Kitchen |
| 🏡 Bathroom & Cloakroom       | 🏡 Porch with Storage               | 🏡 Ample Communal Parking                |
| 🏡 Enclosed Rear Garden       | 🏡 Close To Basingstoke Town Centre | 🏡 NO ONWARD CHAIN                       |





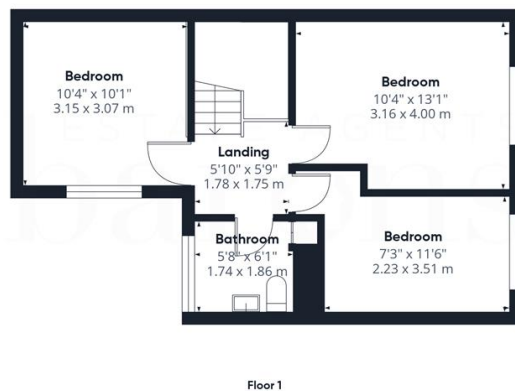
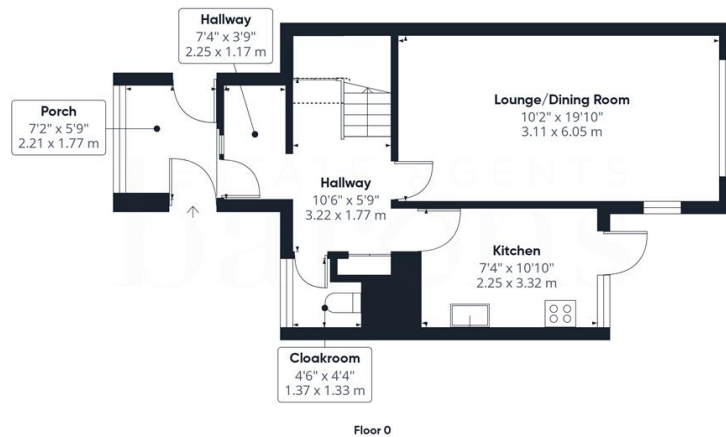

ESTATE AGENTS  
**barons**

**Approximate total area<sup>®</sup>**

856 ft<sup>2</sup>  
79.6 m<sup>2</sup>

**Reduced headroom**

5 ft<sup>2</sup>  
0.4 m<sup>2</sup>

(1) Excluding balconies and terraces

Reduced headroom:

..... Below 5 ft/1.5 m

Calculations reference the RICS IPMS 3C standard. Measurements are approximate and not to scale. This floor plan is intended for illustration only.

GIRAFFE360