



£ 325000

2 Bed House - Mid Terrace, Breadels Field, Beggarwood, Basingstoke

Barons Estate Agents are delighted to present to the market this two bedroom mid terrace family home situated in Beggarwood. Internally, the property benefits from an entrance hallway, cloakroom, lounge, kitchen/dining room, two double bedrooms and family bathroom . Externally, the property features an enclosed rear garden and driveway parking for 2 cars to the rear. The property also benefits from gas central heating and double glazing throughout. A viewing is strongly recommended by the vendor`s sole agent.

Location

Breadels Field is located in Beggarwood and gives you access to M3 junction 7, A303, A30 and A33, along with the mainline railway to London Waterloo from Basingstoke Town Centre. Local doctors surgery, chemist and retail parks are close to hand with the main shopping centre Festival Place a short drive away, offering diverse shopping and restaurant dining.

Tenure

Freehold

Council Tax

Band C

Extra Services

Barons Estate Agents will recommend the services of other businesses and may receive a referral fee in some instances where a buyer or seller uses the services of that company.



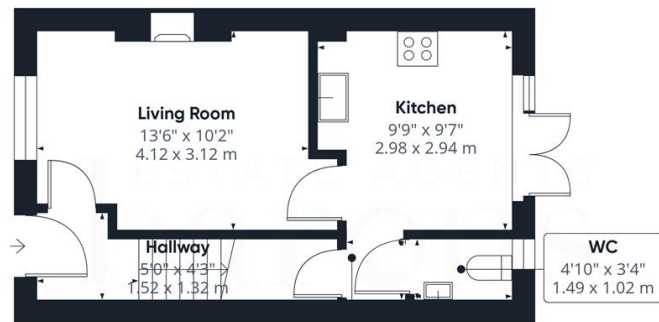

Hallway
3'0" x 3'4"
0.93 x 1.03 m

Floor 0



Floor 1

ESTATE AGENTS
barons

Approximate total area⁽¹⁾
576 ft²
53.6 m²

(1) Excluding balconies and terraces

Calculations reference the RICS IPMS
3C standard. Measurements are
approximate and not to scale. This
floor plan is intended for illustration
only.

GIRAFFE360