



£ 325000

3 Bed House - Mid Terrace, Gainsborough Road, Black Dam, Basingstoke

Barons Estate Agents are delighted to present this three bedroom, mid terrace property, situated in Black Dam. Internally on the ground floor, the accommodation comprises of an entrance hallway with storage, a cloakroom, kitchen, lounge and dining room which offers access to the garden. Upstairs there's three double bedrooms and a family bathroom. Externally, the property boasts an enclosed rear garden, and ample communal parking. Additional benefits include gas central heating, double glazing throughout and NO ONWARD CHAIN. An early viewing would be strongly advised by the vendor's sole agent.

Location

Gainsborough Road gives easy access to M3, A30, A303 and A33 along with a main line railway to London Waterloo. Festival Place offers extensive shopping facilities including Marks and Spencers, and a Waitrose store. There is an abundance of bars and restaurants, two theatres and within a short drive is the Leisure Park providing an ice rink, swimming pool, bowling ally and multi screen cinema. For the keen golfer numerous courses surround the town, as do picturesque walks and village pubs.

Tenure

Freehold

Council Tax

Band C

Extra Services

Barons Estate Agents will recommend the services of other businesses and may receive a referral fee in some instances where a buyer or seller uses the services of that company.

🏠 KEY POINTS & FEATURES

- | | | |
|---------------------------|--------------------------|-----------------------|
| 🏠 Mid Terrace Family Home | 🏠 Three Double Bedrooms | 🏠 Two Reception Rooms |
| 🏠 Family Bathroom | 🏠 Kitchen | 🏠 Cloakroom |
| 🏠 Enclosed Rear Garden | 🏠 Ample Communal Parking | 🏠 Viewing Advised |



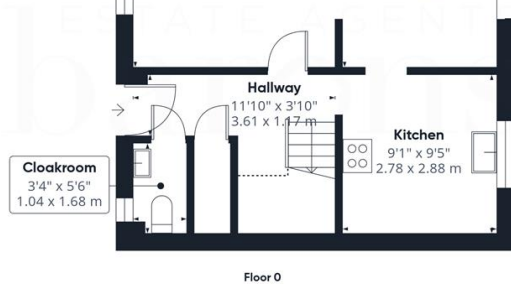

Bedroom
11'7" x 11'5"
3.55 x 3.50 m

Bedroom
9'6" x 11'5"
2.90 x 3.48 m

Landing
11'2" x 2'7"
3.43 x 0.81 m

Bathroom
5'11" x 6'4"
1.81 x 1.94 m

Bedroom
9'3" x 9'7"
2.84 x 2.92 m

GIRAFFE360

