



£ 290000

3 Bed House, Romsey Close, Basingstoke

Barons Estate Agents are pleased to bring to the market this end of terrace family home. The first floor benefits from 3 bedrooms, bathroom and utility cupboard. The ground accommodation comprises of an entrance lobby, entrance hall, cloakroom, kitchen / dining room, lounge and wooden conservatory. To the front of the property there is a gravelled area, flower and shrub bed and path to the front door. The rear garden is fully enclosed with a lawned area and good sized patio along with rear access. No Onward Chain.

## Location

Romsey Close is situated to the North East of the town centre and offers good access to local schools and convenience shops. More extensive shopping is a short drive away at Chineham Shopping Centre and Town Centre Festival Place. The A33 and M3 are easily accessible along with mainline railway to London Waterloo in 45 minutes. For the outdoor person there are country walks, golf courses, National Trust Properties, eateries and pubs abound.

## Local Authority

Basingstoke and Deane Borough Council

## Council Tax

Band C

## Extra Services

Barons Estate Agents will recommend the services of other businesses and may receive a referral fee in some instances where a buyer or seller uses the services of that company.

## 🏠 KEY POINTS & FEATURES

---

🏠 3 Bedrooms

🏠 Entrance Hall

🏠 Lounge

🏠 Bathroom

🏠 Cloakroom

🏠 Wooden Conservatory

🏠 Entrance Lobby

🏠 Kitchen / Dining Room

🏠 Garden





GROUND FLOOR

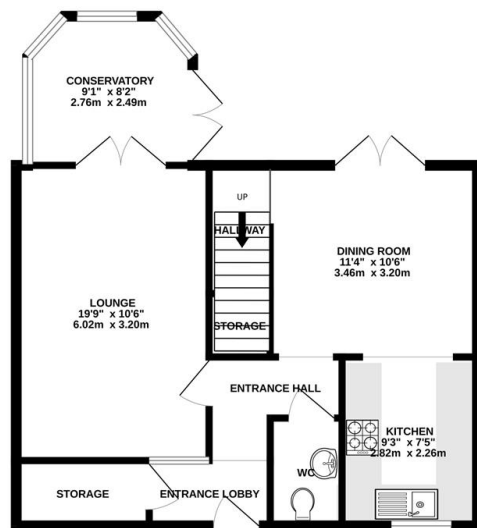

1ST FLOOR

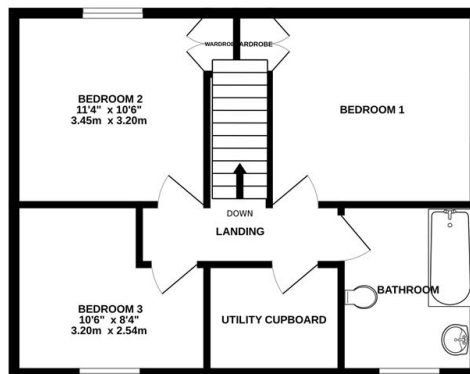

Measurements are approximate. Not to scale. Illustrative purposes only  
Made with Metropix ©2025